

# **OTHER PRODUCTS -TECHNICAL DATA**

	<b>Page</b>
<b>Low Pressure - Industrial Hoses</b>	<b>520</b>
<b>Low Pressure Couplings</b>	<b>521 - 522</b>
<b>Hose Assembly Selection - Installation</b>	<b>523 - 589</b>
<b>Flow Selection Diagram</b>	<b>529</b>
<b>Tread Identification Charts</b>	<b>530</b>
<b>Part.No Equivalence</b>	
<b>Hydra Pipe (Tube-Mac) - GS-Hydro flange parts</b>	<b>531-541</b>
<b>Prefabricated piping spools</b>	<b>542-543</b>

# LOW PRESSURE HOSE & COUPLINGS

Hydra Pipe offers a large selection of industrial hoses and couplings for: Multi-purpose - Cleaning and Wash Down - Steam - Food - Material Handling - Water - Air & Gas - Oil - Chemicals.

Hydra Pipe uses high quality suppliers to make sure that the quality of the products meets the highest industry requirements.



# LOW PRESSURE HOSE & COUPLINGS

## AIR FITTINGS



## BRASS FITTINGS



Hose Stations, Nozzles, Garden Hose Fittings, Garden Hose, Brass Shank Fittings, Brass Fittings, Ferrules, Crimping Tools.

## CAM & GROOVE



Full Range of Cam & Groove to Mill- C-27487, DIN 2828, "Andrews", "Boss-lock", "EZ Boss-lock" Brands, High Pressure Range up to 60 Bar, Stainless Steel, Aluminium, Brass, Bronze, Polypropylene, Reducing Couplers, Adapters, Gaskets, Spares, Accessories, Dry Disconnects, Crimp Style.

## CLAMPS



Heavy Duty & Spiral, Single & Double Bolt Clamps, Worm Gear, Band Clamps, T-Bolt Clamps, Aero Seal. Air, Steam, Hygienic & Industrial Application Clamp Range, Clamp Kits, Tools & Accessories.

## DIN STANDARD PRODUCTS



Storz Couplings, Smooth Tails & Safety Clamps - DIN 2817, Cam & Groove DIN 2828, Fixed & Swivel Flanges (DIN 2817, 2362 & 2673). Hygienic Din Fittings & Clamps, Tank Wagon Couplings (DIN 28450), Spares & Seals, Steam DIN 2826 Male, Female & Flanged Fittings & Couplings.

## FITTINGS & ADAPTERS



Hydraulic Pipe Fittings, Weld End Pipe Fittings, Flanged Fittings, Flanges, Reducers, Threaded Adapters, Plugs, Caps, Swivel Adapters.

## HYGIENIC VALVES & FITTINGS



Couplings (DIN, RJT, SMS, IDF, Tri-Clamp), Clamps, Gaskets, Elbows, Tees, Ferrules, Reducers, Valves (Butterfly, Ball & Check), Sight Glasses, Hose Assemblies, Wash Down Guns, Biopharm, Dairy, Actuated Valves, Bespoke Fabricated Configurations.

## PERMANENTLY ATTACHED FITTINGS -



Plain End Stem, Threaded Stem, Victaulic Groove Stem, Flanged Stem, Ferrules, Hygienic, Industrial, Concrete Placement & Offshore Range, Rotary & High Pressure, Frac Fittings, Internal Swaging Machines & Accessories.

# LOW PRESSURE HOSE & COUPLINGS

## PETROLEUM, DRY BULK & OVERFILL PREVENTION



Adapters & Couplers, Valves, Caps, Gauge Hatches, FloTech™ Overfill Prevention, Nozzles, Pressure & Vacuum Valves, Reducers, Tank Truck Fittings, Shank Couplings, Pipe Caps, Sight Flow Indicators.

## STEAM COUPLINGS & CLAMPS - 'BOSS'



"Boss" & "EZ-boss" Ground Joint & Washer Type Couplings, "Boss" Clamps, Stems & Adapters, Air Hammer Fittings, "Boss"/Holedall Fittings, Steam Quick Disconnects. DIN 2826 Male, Female & Flanged.

## WATER COUPLINGS



Agri Lock, Bauer Type, Hinge Lock, Victaulic, Geka Type, King Shank, King Combination Nipples, Wash Down Guns.



# HOSE ASSEMBLY SELECTION AND INSTALLATION

## 1. CALCULATING HOSE ASSEMBLY LENGTHS

Hose assemblies are made according to overall length i.e. cone face to cone face, or where elbow couplings are used, to the centre line of the cone face.

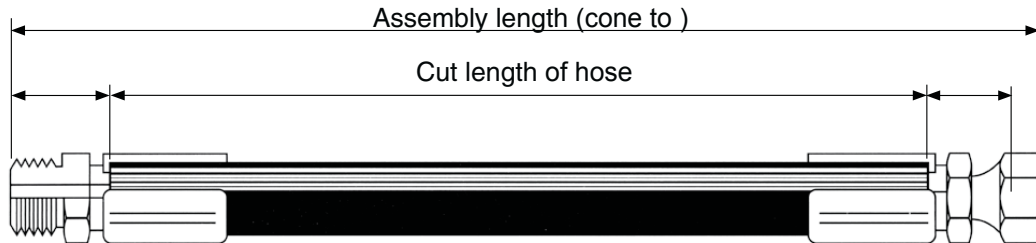

When determining the length of hose assemblies, provide sufficient length to prevent bending strain from localising at the back of the coupling. In the figure below dimension **B** allows for a strain section of hose beyond the coupling to prevent concentration of bending strain. **T** designates the amount of travel. **A** indicates the smallest diameter to which the hose should be bent (2x minimum bend radius).

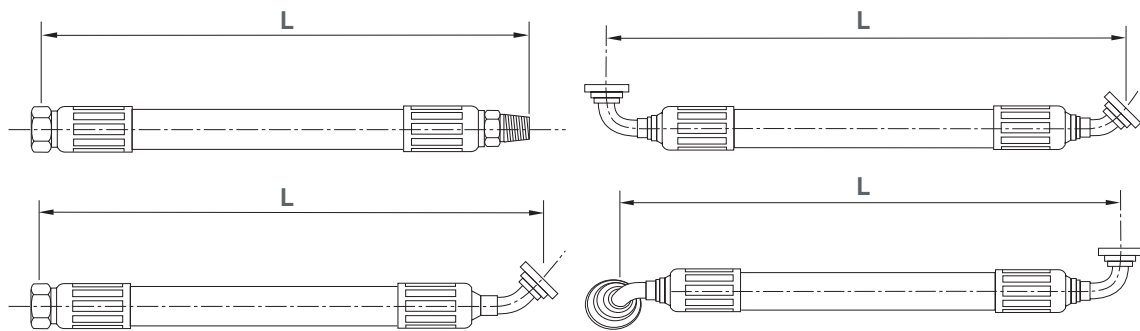

### T (Actuation travel)

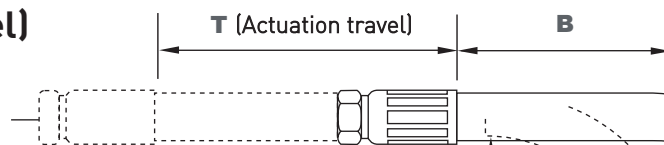

#### Critical dimensions must be observed:

1. Dimension **A** must not be less than 2 times the hose minimum bend radius.
2. Dimension **B**, the minimum free length at each coupling, taking into account **T** the full actuation travel, must not be less than 2 times hose outside diameter.

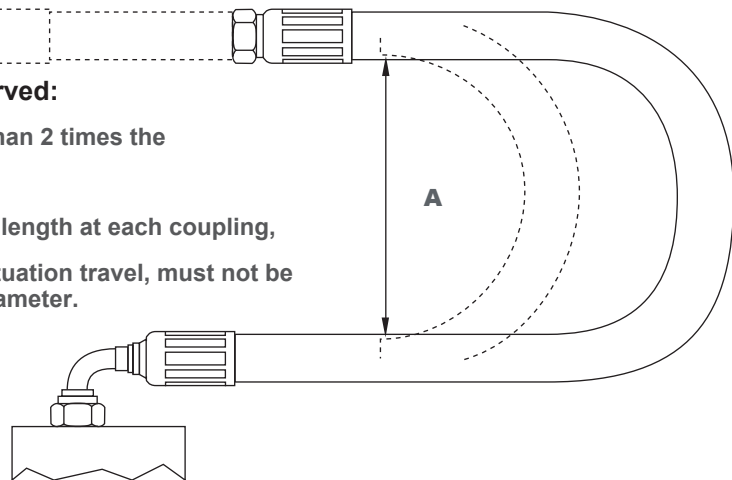

### CAUTION

When cutting hose, always wear safety glasses and avoid loose fitting clothing. Ear protection is also strongly recommended. Ensure adequate ventilation.

# HOSE ASSEMBLY SELECTION AND INSTALLATION

## 2. Fitting orientation

Fitting orientation is necessary when a hose assembly requires two angled couplings that are not in line when viewed from one end of a hose. Fittings must be orientated to each other to ensure proper installation with minimal stress on the hose from twisting.

Fitting orientation is measured from the centerline of the first coupling held in a vertical position and looking at the assembly from the second end by measuring in a clockwise direction.

Orientation angle tolerance should be  $\pm 3$  degrees for assemblies equal or less than 600 mm and  $\pm 5$  degrees for assembly lengths over 600 mm.

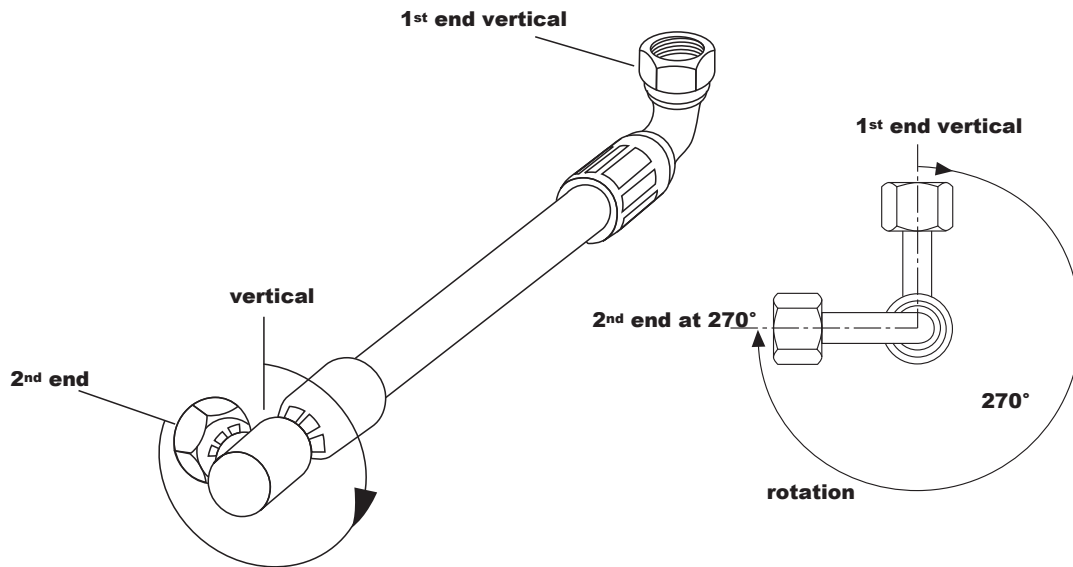

## 3. HOSE ASSEMBLY ROUTING TIPS

Proper hose installation is essential for satisfactory performance. As we have seen, if hose length is excessive, the appearance of the installation will be unsatisfactory and unnecessary cost of equipment will be involved. If hose assemblies are too short to permit adequate flexing and changes in length due to expansion or contraction, hose service life will be reduced.

The following diagrams show proper hose installations which provide maximum performance and cost savings. Consider these examples in determining the length of a specific assembly.

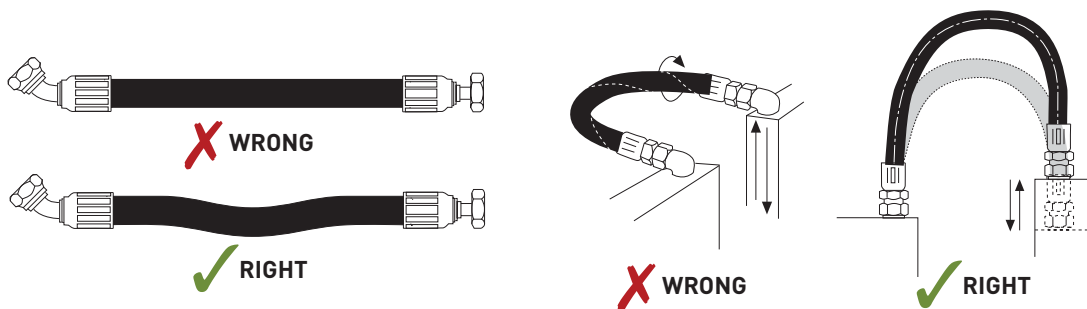

When hose installation is straight, allow enough slack in hose line to provide for length changes which will occur when pressure is applied.

Prevent twisting and distortion by bending hose in same plane as the motion of the boss to which hose is connected.

cont...

# HOSE ASSEMBLY SELECTION AND INSTALLATION

## 3. HOSE ASSEMBLY ROUTING TIPS

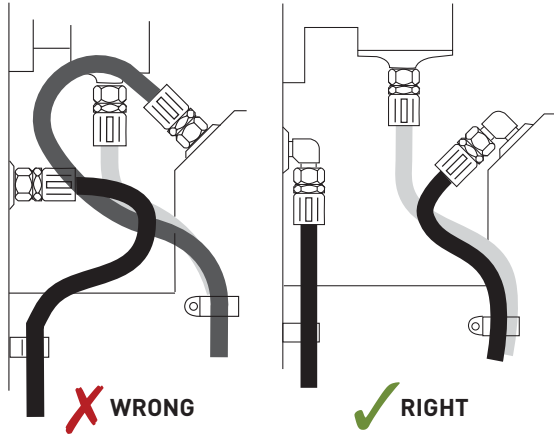

Route hose directly by using 45° and/or 90° adaptors and fittings. Avoid excessive hose length to improve appearance.

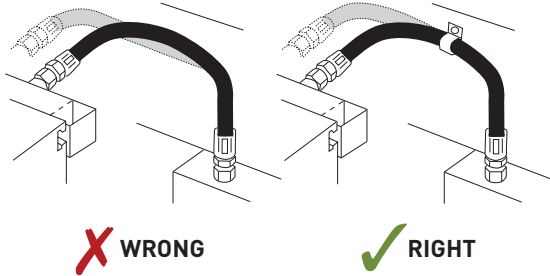

Avoid twisting of hose lines bent in two planes by clamping hose at change of plane.

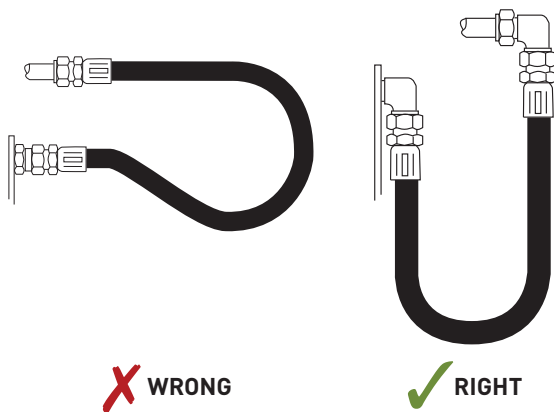

When radius is below the required minimum, use an angle adaptor to avoid sharp bends.

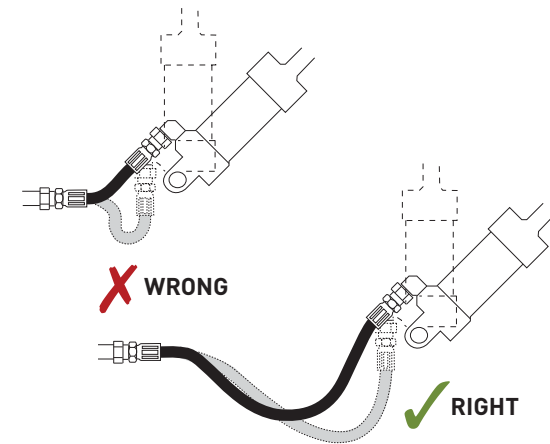

Adequate hose length is necessary to distribute movement on flexing applications and to avoid abrasion.

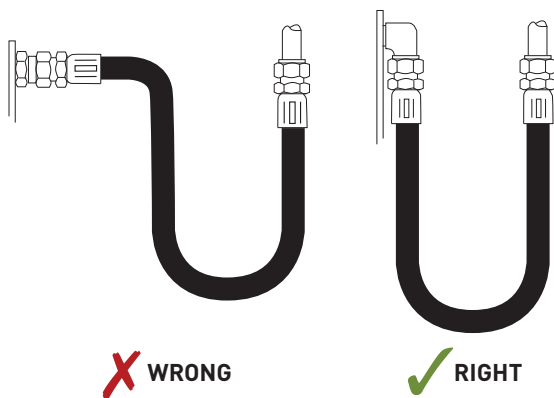

Use proper angle adaptors to avoid sharp twist or bend in hose.

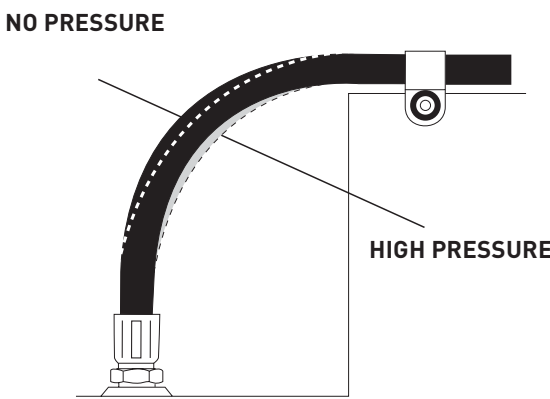

To allow for length changes when hose is pressurised, do not clamp at bends so that curves will absorb changes. Do not clamp high and low pressure lines together.

# HOSE ASSEMBLY SELECTION AND INSTALLATION

## 3. HOSE ASSEMBLY ROUTING TIPS

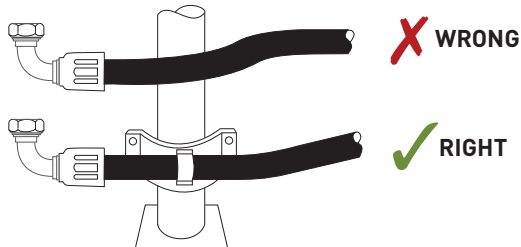

High ambient temperatures shorten hose life. Make sure hose is kept away from hot parts. If this is not possible, insulate the hose.

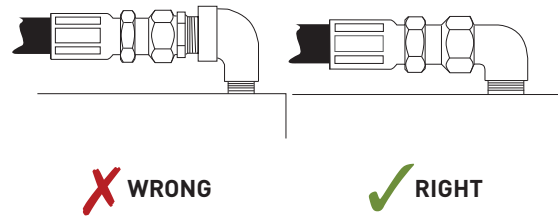

Reduce number of pipe thread joints by using proper hydraulic adaptors instead of pipe fittings.

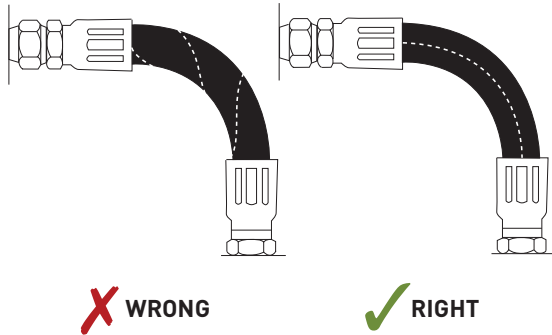

When installing a hose, make sure it is not twisted. Pressure applied to a twisted hose can result in hose failure or loosening of connections.

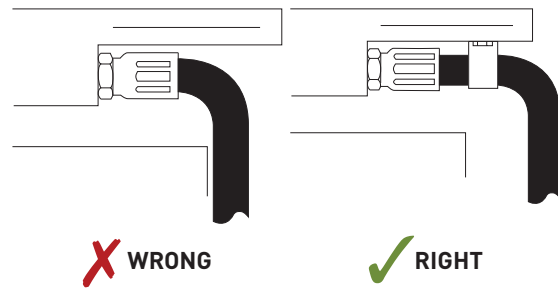

Run hose in the installation so that it avoids rubbing and abrasion. Often, clamps are required to support long hose runs or to keep hose away from moving parts. Use clamps of the correct size. Too large a clamp allows hose to move inside the clamp and causes abrasion.

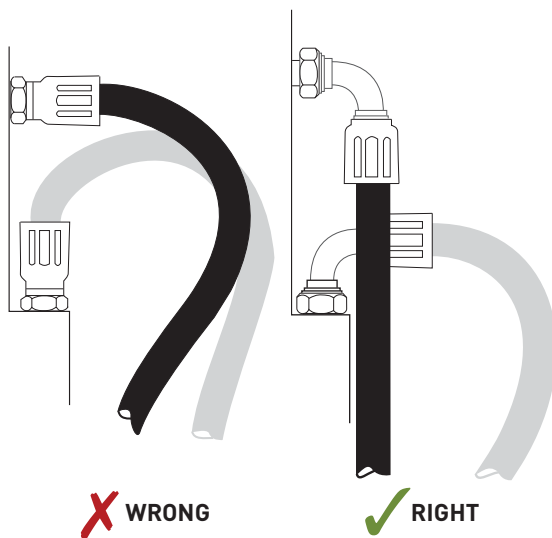

Elbows and adaptors should be used to relieve strain on the assembly, and to provide neater installations which will be more accessible for inspection and maintenance.

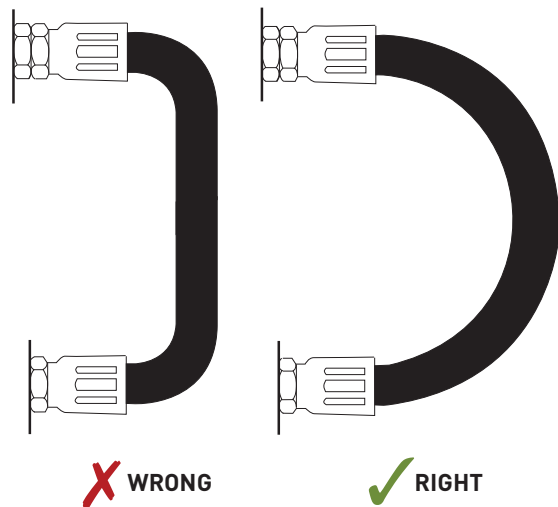



To avoid hose collapse and flow restriction, keep hose bend radii as large as possible. Refer to hose specification tables for minimum bend radii.





# HOSE ASSEMBLY SELECTION AND INSTALLATION

## 4. RECOMMENDED TORQUES HOSE COUPLINGS - ADAPTORS



### SAE 37° & 45°

				
-size	DN		Min.	Max.
-4	6	7/16"- 20	13	15
-5	8	1/2"- 20	18	20
-6	10	9/16"- 18	23	26
-8	12	3/4"- 16	47	52
-10	16	7/8"- 14	69	76
-12	20	1.1/16"- 12	96	106
-16	25	1.5/16"- 12	127	141
-20	32	1.5/8"- 12	169	188
-24	38	1.7/8"- 12	212	235
-32	50	2.1/2"- 12	296	329



### BSP 60° CONE

				
-size	DN		Min.	Max.
-4	6	1/4"- 19	15	18
-6	10	3/8"- 19	26	31
-8	12	1/2"- 14	41	49
-10	16	5/8"- 14	50	60
-12	20	3/4"- 14	70	80
-16	25	1"- 11	105	125
-20	32	1.1/4"- 11	170	190
-24	38	1.1/2"- 11	225	250
-32	50	2"- 11	360	420



### FLAT-FACED 'O' RING SEAL

				
-size	DN		Min.	Max.
-4	6	9/16"- 18	14	16
-6	10	11/16"- 16	24	27
-8	12	13/16"- 16	43	54
-10	16	1"- 14	60	75
-12	20	1.3/16"- 12	90	110
-16	25	1.7/16"- 12	125	140
-20	32	1.11/16"- 12	170	190
-24	38	2"- 12	200	245



### DIN SERIES

				
-size	DN		Min.	Max.
6	-	M12 x 1.5	13	17
8	-	M14 x 1.5	23	28
10	8	M16 x 1.5	33	38
12	10	M18 x 1.5	38	42
-	12	M20 x 1.5	48	52
15	14	M22 x 1.5	52	58
-	16	M24 x 1.5	62	68
18	-	M26 x 1.5	80	90
22	20	M30 x 2	105	115
28	25	M36 x 2	125	135
-	30	M42 x 2	200	220
35	-	M45 x 2	205	225
42	38	M52 x 2	290	310

### O-RING BOSS

						
-size	DN		L series		S series.	
			Min.	Max.	Min.	Max.
-4	6	7/16"- 20	18	20	20	22
-5	8	1/2"- 20	20	25	24	27
-6	10	9/16"- 18	25	30	33	35
-8	12	3/4"- 16	45	50	70	75
-10	16	7/8"- 14	60	70	100	110
-12	20	1.1/16"- 12	95	105	170	180
-14	22	1.3/16"- 12	-	-	215	240
-16	25	1.5/16"- 12	150	170	270	300
-20	32	1.5/8"- 12	180	200	285	315
-24	38	1.7/8"- 12	210	230	370	410

### SAE FLANGES

					
-size	DN	L series		S series.	
		Min.	Max.	Min.	Max.
-8	12	20	25	20	25
-12	20	28	40	34	45
-16	25	37	48	56	68
-20	32	48	62	85	102
-24	38	62	79	158	181
-32	50	75	90	271	294

# HOSE ASSEMBLY SELECTION AND INSTALLATION

## 5. Precautions

### Protection against damage and other troubles

Avoid using the hose assembly beyond the scope of its specifications. It may cause serious problems such as an early burst or leakage. For safe application, note the following instructions:

- **Do not touch the hose and the coupling under pressure.**

*Should a hose or a coupling break, it may cause severe injuries, such as burn or destruction of your organs. Apply plastic cover for protection, unless the contact with them can be avoidable.*

- **Use a hose under the maximum working pressure.**

*The use over the maximum working pressure may lead to burst of a hose or a coupling come-off. Follow the maximum working pressure guided in its specification.*

- **Do not hurt the hose.**

*To protect hose assemblies from excessive wear caused by sharp objects or abrasive materials, use open wound or flat armor spring guards.*

- **Avoid using a hose with a twist or a pull.**

*Should the twisted or pulled hose be applied with a pressure, the hose, particularly the hose end, may possibly suffer a break. If it is unavoidable, be sure to use a swivel joint.*

- **Avoid using a hose with a sharp bend.**

*The use of a hose with a sharp bend may cause an early break or other unexpected troubles. Utilize proper adapters or spring guards to avoid excessive bending.*

- **Do not be electrified.**

*Electrifying a hose may lead to a break of the hose or an electric shock.*

- **Tighten the recommended torque.**

*When a hose is connected to machine, be sure to apply the recommended torque.*

- **Apply the appropriate fluid.**

*The use of the inappropriate fluid will deteriorate the inner tube or the reinforcement, which will lead to burst of a hose or a coupling come-off.*

- **Keep the minimum bending radius.**

*When the hose is bent smaller than the minimum bending radius, it may cause early burst.*

- **Do not put the external force such as excessive impulse.**

*Under the excessive external force, the service will decline.*

- **Keep the temperature range.**

*The use of a hose over the temperature range will lead to burst or problems around the coupling, such as leakage, or come-off.*

- **Do not put the excessive negative pressure.**

*Under the excessive negative pressure, the inner tube will scrape, which will lead to leakage.*

- **Do not put into the water or any other liquid.**

*In water, the hose undergoes external pressure, which will reduce the service life of a hose.*

- **Remove the air inside.**

*The air left inside may cause the scrape of inner tube, which will lead to leakage.*

- **Keep the minimum exposed hose length.**

*To acquire the service life of the hose, keep at least the minimum exposed hose length.*

- **Do not fix or remodel a hose.**

*The fixed or remodeled hose does not show the service life of the specification.*

### Fluid compatibility

- For use with water based fluid maximum temperature is +70°C (+158°F);

- For the use with any other fluid (biodegradable hydraulic fluids, oil-based hydraulic fluids with special additives and medium different from oil-based fluids) please ask us the compatibility.

### Maintenance

At the inception, be sure that none of the following can be found.

- Damage of a hose
- Swelling of a hose
- Exposure of a Reinforcement
- Transformation (ex. sharp bending)

### Storage

- Avoid direct rays of the sun, noxious gasses, oils and chemicals.
- Store in dry place at temperature range of -10°C to +40°C

# HOSE FLOW SELECTION

## Flow capacity nomogram

Flow capacities of Intertraco hose at recommended flow velocities

The chart below is provided as an aid in the determination of the correct hose size.

### Example:

at 45l/min (12 Gal/min), what is the proper hose size within the recommended velocity range for pressure lines? Locate 45 l/min (12 Gal/min) in the left-hand column and 7,6 m/s (25 ft/s) in the right-hand column (the maximum recommended velocity range for pressure lines). Lay a straight line across these two points. The inside diameter shown in the centre column is below -8 so we have to use -8 (1/2").

For suction hose, follow the same procedure but use recommended velocity range for intake lines in the right hand column.

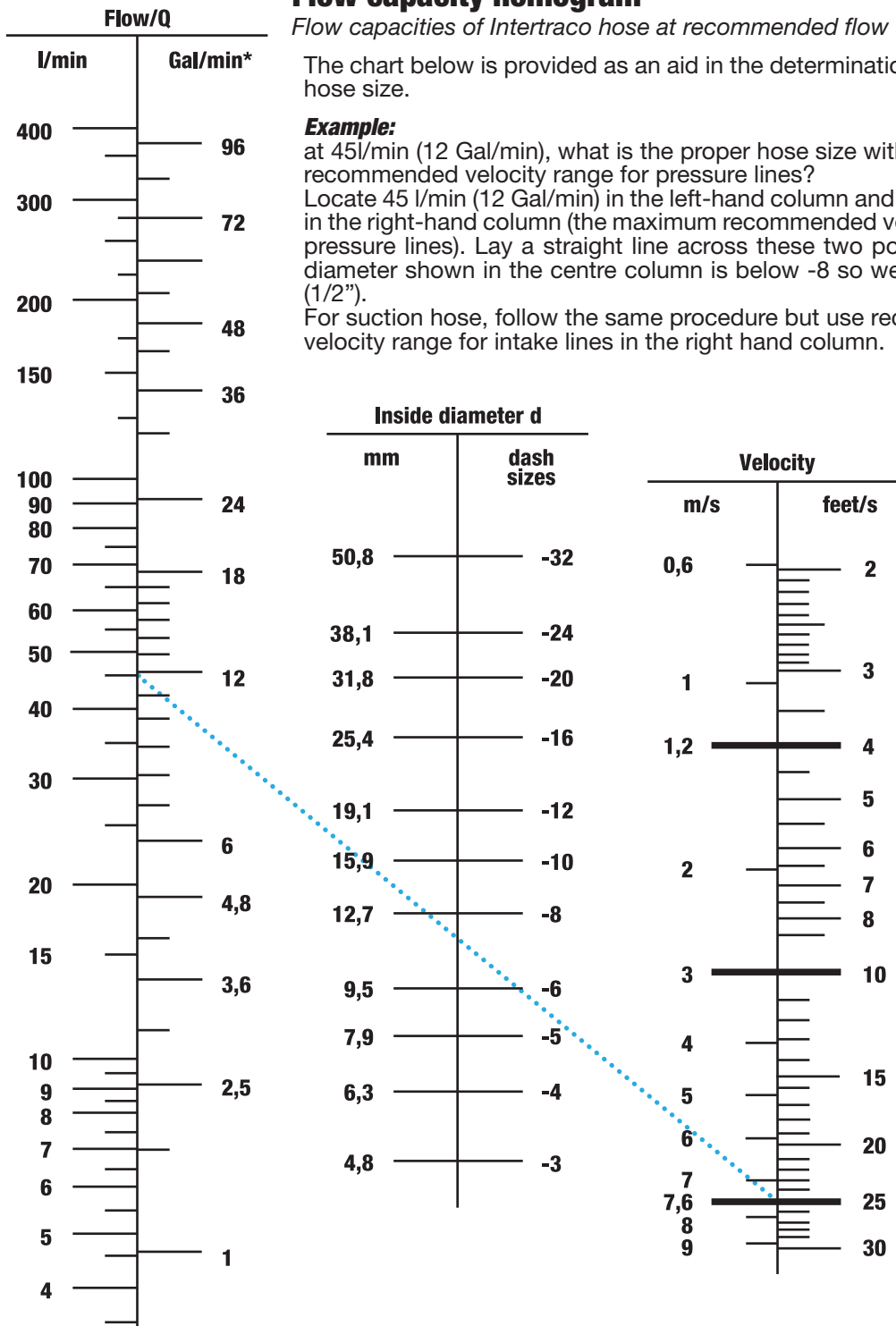

**Q** = flow in liter per minute or US Gallons per minute      **V** = velocity in meter per seconds or feet per seconds  
**d** = hose inside diameter (mm /dash size)

\* Gallons are US gallons - Conversion rate: Gal/min x 3,785=l/min - feet/s x 0,3048=m/s

\* Recommended velocities are according to hydraulic fluids of maximum viscosity 315 S.S.U. at 38°C (100°F) working at room temperatures within 18°C (65°F) and 68°C (155°F).

# DASH SIZE AND TREAD IDENTIFICATION CHARTS

## Hose - BSP - NPT - JIC - SAE - ORFS

DASH SIZE	Hose I.D.	BSP	NPT	JIC 37° & SAE O-RING	O.R.F.S Flat Face	INVERTED FLARE	45° SAE FLARE	CODE 61 FLANGE	CODE 62 FLANGE
-02	1/8"	1/8-28	1/8-27	5/16-24		5/16-28	5/16-24		
-03	3/16"	N/A	N/A	3/8-24		3/8-24	3/8-24		
-04	1/4"	1/4-19	1/4-18	7/16-20	9/16-18	7/16-24	7/16-20		
-05	5/16"	N/A	N/A	1/2-20		1/2-24	1/2-20		
-06	3/8"	3/8-19	3/8-18	9/16-18	11/16-16	9/16-24	5/8-18		
-07	7/16"	N/A	N/A	-		5/8-24	11/16-16		
-08	1/2"	1/2-14	1/2-14	3/4-16	13/16-16	11/16-20	3/4-16	1/2	1/2
-10	5/8"	5/8	N/A	7/8-14	1-14	13/16-18	7/8-14		
-12	3/4"	3/4-14	3/4-14	1 1/16-12	1 3/16-12	1-18	1 1/16-14	3/4	3/4
-14	7/8"	N/A	N/A	1 3/16-12					
-16	1"	1-11	1-11 1/2	1 5/16-12	1 7/16-12			1	1
-20	1 1/4"	1 1/4-11	1 1/4-11 1/2	1 5/8-12	1 11/16-12			1 1/4	1 1/4
-24	1 1/2"	1 1/2-11	1 1/2-11 1/2	1 7/8-12	2-12			1 1/2	1 1/2
-32	2"	2-11	2-11 1/2	2 1/2-12				2	2

## Metric ISO8434-1 - DIN2353

Tube O.D.		LL DIN2353 ISO 8434-1	L DIN2353 ISO 8434-1	S DIN2353 ISO 8434-1
4MM	<b>4LL</b>	8MM X 1.0		
6MM	<b>6LL</b>	10MM X 1.0		
8MM	<b>8LL</b>	12MM X 1.0		
10MM	<b>10LL</b>	14MM X 1.0		
12MM	<b>12LL</b>	16MM X 1.0		
6MM	<b>6L/S</b>		12 MM X 1.5	14 MM X 1.5
8MM	<b>8L/S</b>		14 MM X 1.5	16 MM X 1.5
10MM	<b>10L/S</b>		16 MM X 1.5	18 MM X 1.5
12MM	<b>12L/S</b>		18 MM X 1.5	20 MM X 1.5
14MM	<b>14S</b>			22 MM X 1.5
15 MM	<b>15L</b>		22 MM X 1.5	
16 MM	<b>16S</b>			24 MM X 1.5
18 MM	<b>18L</b>		26 MM X 1.5	
20 MM	<b>20S</b>			30 MM X 2.0
22 MM	<b>22L</b>		30 MM X 2.0	
25 MM	<b>25S</b>			36 MM X 2.0
28 MM	<b>28L</b>		36 MM X 2.0	
30 MM	<b>30S</b>			42 MM X 2.0
35 MM	<b>35L</b>		45 MM X 2.0	
38 MM	<b>38S</b>			52 MM X 2.0
42 MM	<b>42L</b>		52 MM X 2.0	

## Part.No Equivalence Hydra Pipe (Tube-Mac) - GS-Hydro flange parts

GS-Hydro	Hydra Pipe	GS-Hydro	Hydra Pipe
08	R-050	20099	OCP-125
12	R-075	20114	NTA-125-125
16	R-100	24013	FBTA150-125
20	R-125	24014	BTA-150-150
24	R-150	24015	RRE24
32	R-200	24016	RRT24
40	R-250	24018	RFE-150
48	R-300	24018	RFE24
56	R-400	24019	RFBH-150
308	RFC34-050	24099	OCP-150
312	RFC34-075	24114	NTA-150-150
316	RFC34-100	32013	FBTA200-200
320	RFC34-150	32014	BTA-200-200
324	RFC34-200	32015	RRE32
332	RFC34-250	32016	RRT32
340	RFC34-300	32018	RFE-200
348	RFC34-400	32018	RFE32
432	RFC74-200	32019	RFBH-200
440	RFC74-250	32099	OCP-200
448	RFC74-300	32114	NTA-200-200
456	RFC74-400	40015	RRE40
608	RFC64-050	40016	RRT40
612	RFC64-075	40018	RFE-250
616	RFC64-100	40018	RFE40
620	RFC64-125	40019	RFBH-250
624	RFC64-150	48015	RRE48
632	RFC64-200	48016	RRT48
8014	BTA-050-050	48018	RFE-300
8019	RFBH-050	48018	RFE48
8099	OCP-050	48019	RFBH-300
8114	NTA-050-050	56018	RFE-400
12013	FBTA075-075	56019	RFBH-400
12014	BTA-075-075	64018	RFE64
12015	RRE12	308116	BTM34-050
12018	RFE12	316116	BTM34-100
12019	RFBH-075	320116	BTM34-125
12099	OCP-075	324116	BTM34-150
12114	NTA-075-075	332116	BTM34-200
16013	FBTA100-075	340116	BTM34-250
16014	BTA-100-100	348116	BTM34-300
16015	RRE16	440116	BTM74-250
16018	RFE16	448116	BTM74-300
16019	RFBH-100	608116	BTM64-050
16099	OCP-100	612116	BTM64-075
20013	FBTA125-100	616116	BTM64-100
20014	BTA-125-125	620116	BTM64-125
20015	RRE20	624116	BTM64-150
20016	RRT20	632116	BTM64-200
20018	RFE20	08/20X3 FA	CO-20X3-050
20019	RFBH-125	08/20X3 FA SS	CO-20X3-050 SS

## Part.No Equivalence Hydra Pipe (Tube-Mac) - GS-Hydro flange parts

GS-Hydro	Hydra Pipe	GS-Hydro	Hydra Pipe
08/20X3 FB	CF-20X3-050	12014-R1/2	BTA-075-050
08/20X3 FB SS	CF-20X3-050 SS	12014-R1/2 SS	BTA-075-050 SS
08/21.34X2.77 FA	CO-SCH40-050	12016	RRT12
08/21.34X2.77 FA SS	CO-SCH40-050 SS	12019 SS	RFBH-075 SS
08/21.34X2.77 FB	CF-SCH40-050	12099 SS	OCP-075 SS
08/21.34X2.77 FB SS	CF-SCH40-050 SS	12114 SS	NTA-075-075 SS
08/21.34X3.73 FA	CO-SCH80-050	12114-1	NTA-075-100
08/21.34X3.73 FA SS	CO-SCH80-050 SS	12114-1 SS	NTA-075-100 SS
08/21.34X3.73 FB	CF-SCH80-050	12114-1/2	NTA-075-050
08/21.34X3.73 FB SS	CF-SCH80-050 SS	12114-1/2 SS	NTA-075-050 SS
08/25X2.5 FA	CO-25X2.5-050	16/25X3 FA	COR-25X3-100X075
08013	FBTA050-025	16/25X3 FA SS	COR-25X3-100X075SS
08014 SS	BTA-050-050 SS	16/25X3 FB	CFR-25X3-100X075
08014-3/4 SS	BTA-050-075 SS	16/25X3 FB SS	CFR-25X3-100X075SS
08014-R3/4	BTA-050-075	16/26.67X2.81 FA	COR-SCH40-100X075
08015	RRE08	16/26.67X2.81 FA	CORSCH40-100X075SS
08016	RRT08	16/26.67X2.81 FB	CFR-SCH40-100X075
08018	RFE08	16/26.67X2.81 FB	CFRSCH40-100X075SS
08019 SS	RFBH-050 SS	16/26.67X3.91 FA	COR-SCH80-100X075
08099 SS	OCP-050 SS	16/26.67X3.91 FA	CORSCH80-100X075SS
08114 SS	NTA-050-050 SS	16/26.67X3.91 FB	CFR-SCH80-100X075
08114-3/4	NTA-050-075	16/26.67X3.91 FB	CFRSCH80-100X075SS
08114-3/4 SS	NTA-050-075 SS	16/30X4 FA	CO-30X4-100
12/20X3 FA	COR-20X3-075X050	16/30X4 FA SS	CO-30X4-100 SS
12/20X3 FA SS	COR-20X3-075X050SS	16/30X4 FB	CF-30X4-100
12/20X3 FB	CFR-20X3-075X050	16/30X4 FB SS	CF-30X4-100 SS
12/20X3 FB SS	CFR-20X3-075X050SS	16/33.4X3.38 FA	CO-SCH40-100
12/21.34X2.77 FA	COR-SCH40-075X050	16/33.4X3.38 FA SS	CO-SCH40-100 SS
12/21.34X2.77 FA SS	CORSCH40-	16/33.4X3.38 FB	CF-SCH40-100
12/21.34X2.77 FB	CFR-SCH40-075X050	16/33.4X3.38 FB SS	CF-SCH40-100 SS
12/21.34X2.77 FB SS	CFRSCH40-075X050SS	16/33.4X4.55 FA	CO-SCH80-100
12/21.34X3.73 FA	COR-SCH80-075X050	16/33.4X4.55 FA SS	CO-SCH80-100 SS
12/21.34X3.73 FA SS	CORSCH80-	16/33.4X4.55 FB	CF-SCH80-100
12/21.34X3.73 FB	CFR-SCH80-075X050	16/33.4X4.55 FB SS	CF-SCH80-100 SS
12/21.34X3.73 FB SS	CFRSCH80-075X050SS	16/38X4 FA	CO-38X4-100
12/25X3 FA	CO-25X3-075	16/38X4 FA SS	CO-38X4-100 SS
12/25X3 FA SS	CO-25X3-075 SS	16/38X4 FB	CF-38X4-100
12/25X3 FB	CF-25X3-075	16/38X4 FB SS	CF-38X4-100 SS
12/25X3 FB SS	CF-25X3-075 SS	16014 SS	BTA-100-100 SS
12/26.67X2.81 FA	CO-SCH40-075	16014-R11/4	BTA-100-125
12/26.67X2.81 FA SS	CO-SCH40-075 SS	16014-R11/4 SS	BTA-100-125 SS
12/26.67X2.81 FB	CF-SCH40-075	16014-R3/4	BTA-100-075
12/26.67X2.81 FB SS	CF-SCH40-075 SS	16014-R3/4 SS	BTA-100-075 SS
12/26.67X3.91 FA	CO-SCH80-075	16016	RRT16
12/26.67X3.91 FA SS	CO-SCH80-075 SS	16019 SS	RFBH-100 SS
12/26.67X3.91 FB	CF-SCH80-075	16099 SS	OCP-100 SS
12/26.67X3.91 FB SS	CF-SCH80-075 SS	16114	NTA-100-100
12014 SS	BTA-075-075 SS	16114 SS	NTA-100-100 SS
12014-R1	BTA-075-100	16114-11/4	NTA-100-125
12014-R1 SS	BTA-075-100 SS	16114-11/4 SS	NTA-100-125 SS



## Part.No Equivalence Hydra Pipe (Tube-Mac) - GS-Hydro flange parts

GS-Hydro	Hydra Pipe	GS-Hydro	Hydra Pipe
16114-3/4	NTA-100-075	20114 SS	NTA-125-125 SS
16114-3/4 SS	NTA-100-075 SS	20114-1	NTA-125-100
164 125	BFOM34-400	20114-1 SS	NTA-125-100 SS
164 125 SS	BFOM34-400 SS	20114-11/2	NTA-125-150
164/114.3F	FFC34-400	20114-11/2 SS	NTA-125-150 SS
164/114.3F SS	FFC34-400 SS	24/38X4 FA	COR-38X4-150X125
164F	FFCM34-400-115MM	24/38X4 FA SS	COR-38X4-150X125SS
164F SS	FFCM34-400-115MM	24/38X4 FB	CFR-38X4-150X125
20/30X4 FA	COR-30X4-125X100	24/38X4 FB SS	CFR-38X4-150X125SS
20/30X4 FA SS	COR-30X4-125X100SS	24/42.16X3.56 FA	COR-SCH40-150X125
20/30X4 FB	CFR-30X4-125X100	24/42.16X3.56 FA	CORSCH40-150X125SS
20/30X4 FB SS	CFR-30X4-125X100SS	24/42.16X3.56 FB	CFR-SCH40-150X125
20/33.4X3.38 FA	COR-SCH40-125X100	24/42.16X3.56 FB	CFRSCH40-150X125SS
20/33.4X3.38 FA SS	CORSCH40-	24/42.16X4.85 FA	COR-SCH80-150X125
20/33.4X3.38 FB	CFR-SCH40-125X100	24/42.16X4.85 FA	CORSCH80-150X125SS
20/33.4X3.38 FB SS	CFRSCH40-125X100SS	24/42.16X4.85 FB	CFR-SCH80-150X125
20/33.4X4.55 FA	COR-SCH80-125X100	24/42.16X4.85 FB	CFRSCH80-150X125SS
20/33.4X4.55 FA SS	CORSCH80-	24/42X3 FA	CO-42X3-150
20/33.4X4.55 FB	CFR-SCH80-125X100	24/48.26X3.68 FA	CO-SCH40-150
20/33.4X4.55 FB SS	CFRSCH80-125X100SS	24/48.26X3.68 FA	CO-SCH40-150 SS
20/38X4 FA	CO-38X4-125	24/48.26X3.68 FB	CF-SCH40-150
20/38X4 FA SS	CO-38X4-125 SS	24/48.26X3.68 FB	CF-SCH40-150 SS
20/38X4 FB	CF-38X4-125	24/48.26X5.08 FA	CO-SCH80-150
20/38X4 FB SS	CF-38X4-125 SS	24/48.26X5.08 FA	CO-SCH80-150 SS
20/38X6 FA	CO-38X6-125	24/48.26X5.08 FB	CF-SCH80-150
20/42.16X3.56 FA	CO-SCH40-125	24/48.26X5.08 FB	CF-SCH80-150 SS
20/42.16X3.56 FA SS	CO-SCH40-125 SS	24/48.26X7.14 FA	CO-SCH160-150
20/42.16X3.56 FB	CF-SCH40-125	24/48.26X7.14 FA	CO-SCH160-150 SS
20/42.16X3.56 FB SS	CF-SCH40-125 SS	24/48.26X7.14 FB	CF-SCH160-150
20/42.16X4.85 FA	CO-SCH80-125	24/48.26X7.14 FB	CF-SCH160-150 SS
20/42.16X4.85 FA SS	CO-SCH80-125 SS	24/50X3 FA	CO-50X3-150
20/42.16X4.85 FB	CF-SCH80-125	24/50X3 FA SS	CO-50X3-150 SS
20/42.16X4.85 FB SS	CF-SCH80-125 SS	24/50X3 FB	CF-50X3-150
20/42X3 FA	CO-42X3-125	24/50X3 FB SS	CF-50X3-150 SS
20/42X3 FA SS	CO-42X3-125 SS	24/50X5 FA	CO-50X5-150
20/42X3 FB	CF-42X3-125	24/50X5 FA SS	CO-50X5-150 SS
20/42X3 FB SS	CF-42X3-125 SS	24/50X5 FB	CF-50X5-150
20/42X4 FA	CO-42X4-125	24/50X5 FB SS	CF-50X5-150 SS
20/42X4 FA SS	CO-42X4-125 SS	24/50X6 FA	CO-50X6-150
20/42X4 FB	CF-42X4-125	24/50X6 FA SS	CO-50X6-150 SS
20/42X4 FB SS	CF-42X4-125 SS	24/50X6 FB	CF-50X6-150
20/42X5 FA	CO-42X5-125	24/50X6 FB SS	CF-50X6-150 SS
20/42X5 FB	CF-42X5-125	24014 SS	BTA-150-150 SS
20014 SS	BTA-125-125 SS	24014-R11/2	BTA-150-200
20014-R1	BTA-125-100	24014-R11/2 SS	BTA-150-200 SS
20014-R1 SS	BTA-125-100 SS	24014-R11/4	BTA-150-125
20014-R11/2	BTA-125-150	24014-R11/4 SS	BTA-150-125 SS
20014-R11/2 SS	BTA-125-150 SS	24018 SS	RFE-150 SS
20019 SS	RFBH-125 SS	24019 SS	RFBH-150 SS
20099 SS	OCP-125 SS	24099 SS	OCP-150 SS

## Part.No Equivalence Hydra Pipe (Tube-Mac) - GS-Hydro flange parts

GS-Hydro	Hydra Pipe	GS-Hydro	Hydra Pipe
24114 SS	NTA-150-150 SS	316/312/316 116	BTRM34-100X075
24114-11/2	NTA-150-200	316/312/316 116 SS	BTRM34-100X075 SS
24114-11/2 SS	NTA-150-200 SS	316/33.4F	FFC34-100
24114-11/4	NTA-150-125	316/33.4F SS	FFC34-100 SS
24114-11/4 SS	NTA-150-125 SS	316/M10	RFTM34-100
308 115	BEM34-050	316/M10 SS	RFTM34-100 SS
308 115 SS	BEM34-050 SS	316F	FFCM34-100-38MM
308 116 SS	BTM34-050 SS	316F SS	FFCM34-100-38MM SS
308 125	BFOM34-050	316F/M10	FFTM34-100-38MM
308 125 SS	BFOM34-050 SS	316F/M10 SS	FFTM34-100-38MM SS
308 125B	BFFM34-050	32/48.26X3X68 FA	COR-SCH40-200X150
308 125B SS	BFFM34-050 SS	32/48.26X3X68 FA	CORSCH40-200X150SS
308 SS	RFC34-050 SS	32/48.26X3X68 FB	CFR-SCH40-200X150
308/21.3F	FFC34-050	32/48.26X3X68 FB	CFRSCH40-200X150SS
308/21.3F SS	FFC34-050 SS	32/48.26X5.08 FA	COR-SCH80-200X150
308/M8	RFTM34-050	32/48.26X5.08 FA	CORSCH80-200X150SS
308/M8 SS	RFTM34-050 SS	32/48.26X5.08 FB	CFR-SCH80-200X150
308F	FFCM34-050-25MM	32/48.26X5.08 FB	CFRSCH80-200X150SS
308F SS	FFCM34-050-25MM SS	32/50X5 FA	COR-50X5-200X150
308F/M8	FFTM34-050-25MM	32/50X5 FA SS	COR-50X5-200X150SS
308F/M8 SS	FFTM34-050-25MM SS	32/50X5 FB	CFR-50X5-200X150
312 115	BEM34-075	32/50X5 FB SS	CFR-50X5-200X150SS
312 115	BTM34-075	32/60.3X3.91 FA	CO-SCH40-200
312 115 SS	BEM34-075 SS	32/60.3X3.91 FA SS	CO-SCH40-200 SS
312 115 SS	BTM34-075 SS	32/60.3X3.91 FB	CF-SCH40-200
312 125	BFOM34-075	32/60.3X3.91 FB SS	CF-SCH40-200 SS
312 125 SS	BFOM34-075 SS	32/60.3X5.54 FA	CO-SCH80-200
312 125B	BFFM34-075	32/60.3X5.54 FA SS	CO-SCH80-200 SS
312 125B SS	BFFM34-075 SS	32/60.3X5.54 FB	CF-SCH80-200
312 SS	RFC34-075 SS	32/60.3X5.54 FB SS	CF-SCH80-200 SS
312/26.7F	FFC34-075	32/60.3X8.74 FA	CO-SCH160-200
312/26.7F SS	FFC34-075 SS	32/60.3X8.74 FA SS	CO-SCH160-200 SS
312/308/312 116	BTRM34-075X050	32/60.3X8.74 FB	CF-SCH160-200
312/308/312 116 SS	BTRM34-075X050 SS	32/60.3X8.74 FB SS	CF-SCH160-200 SS
312/M10	RFTM34-075	32/60X3 FA	CO-60X3-200
312/M10 SS	RFTM34-075 SS	32/60X3 FA SS	CO-60X3-200 SS
312F	FFCM34-075-30MM	32/60X3 FB	CF-60X3-200
312F SS	FFCM34-075-30MM SS	32/60X3 FB SS	CF-60X3-200 SS
312F/M10	FFTM34-075-30MM	32/60X4 FA	CO-60X4-200
312F/M10 SS	FFTM34-075-30MM SS	32/60X4 FB	CF-60X4-200
316 115	BEM34-100	32/60X5 FA	CO-60X5-200
316 115 SS	BEM34-100 SS	32/60X5 FA SS	CO-60X5-200 SS
316 116 SS	BTM34-100 SS	32/60X5 FB	CF-60X5-200
316 125	BFOM34-100	32/60X5 FB SS	CF-60X5-200 SS
316 125 SS	BFOM34-100 SS	32/60X6 FA	CO-60X6-200
316 125B	BFFM34-100	32/60X6 FA SS	CO-60X6-200 SS
316 125B SS	BFFM34-100 SS	32/60X6 FB	CF-60X6-200
316 SS	RFC34-100 SS	32/60X6 FB SS	CF-60X6-200 SS
316/308/316 116	BTRM34-100X050	32/60X8 FA	CO-60X8-200
316/308/316 116 SS	BTRM34-100X050 SS	320 115	BEM34-125

## Part.No Equivalence Hydra Pipe (Tube-Mac) - GS-Hydro flange parts

GS-Hydro	Hydra Pipe	GS-Hydro	Hydra Pipe
320 115 SS	BEM34-125 SS	324/M12 SS	RFTM34-150 SS
320 116 SS	BTM34-125 SS	324F	FFCM34-150-50MM
320 125	BFOM34-125	324F SS	FFCM34-150-50MM SS
320 125 SS	BFOM34-125 SS	324F/M12	FFTM34-150-50MM
320 125B	BFFM34-125	324F/M12 SS	FFTM34-150-50MM SS
320 125B SS	BFFM34-125 SS	332 115	BEM34-200
320 SS	RFC34-150 SS	332 115 SS	BEM34-200 SS
320/308/320 116	BTRM34-125X050	332 116 SS	BTM34-200 SS
320/308/320 116 SS	BTRM34-125X050 SS	332 125	BFOM34-200
320/312/320 116	BTRM34-125X075	332 125 SS	BFOM34-200 SS
320/312/320 116 SS	BTRM34-125X075 SS	332 125B	BFFM34-200
320/316/320 116	BTRM34-125X100	332 125B SS	BFFM34-200 SS
320/316/320 116 SS	BTRM34-125X100 SS	332 SS	RFC34-250 SS
320/42.2F	FFC34-125	332/308/332 116	BTRM34-200X050
320/42.2F SS	FFC34-125 SS	332/308/332 116 SS	BTRM34-200X050 SS
320/M10	RFTM34-125	332/312/332 116	BTRM34-200X075
320/M10 SS	RFTM34-125 SS	332/312/332 116 SS	BTRM34-200X075 SS
32014 SS	BTA-200-200 SS	332/316/332 116	BTRM34-200X100
32014-R11/2	BTA-200-150	332/316/332 116 SS	BTRM34-200X100 SS
32014-R11/2 SS	BTA-200-150 SS	332/320/332 116	BTRM34-200X125
32018 SS	RFE-200 SS	332/320/332 116 SS	BTRM34-200X125 SS
32019 SS	RFBH-200 SS	332/324/332 116	BTRM34-200X150
32099 SS	OCP-200 SS	332/324/332 116 SS	BTRM34-200X150 SS
320F	FFCM34-125-42MM	332/60.3F	FFC34-200
320F SS	FFCM34-125-42MM SS	332/60.3F SS	FFC34-200 SS
320F/M10	FFTM34-125-42MM	332/M12	RFTM34-200
320F/M10 SS	FFTM34-125-42MM SS	332/M12 SS	RFTM34-200 SS
32114 SS	NTA-200-200 SS	332F	FFCM34-200-600MM
32114-11/2	NTA-200-150	332F SS	FFCM34-200-60MM SS
32114-11/2 SS	NTA-200-150 SS	332F/M12	FFTM34-200-600MM
32-20	CR-200X125	332F/M12 SS	FFTM34-200-60MM SS
324 115	BEM34-150	340 115	BEM34-250
324 115 SS	BEM34-150 SS	340 115 SS	BEM34-250 SS
324 116 SS	BTM34-150 SS	340 116 SS	BTM34-250 SS
324 125	BFOM34-150	340 125	BFOM34-250
324 125 SS	BFOM34-150 SS	340 125 SS	BFOM34-250 SS
324 125B	BFFM34-150	340 125B	BFFM34-250
324 125B SS	BFFM34-150 SS	340 125B SS	BFFM34-250 SS
324 SS	RFC34-200 SS	340 SS	RFC34-300 SS
324/308/324 116	BTRM34-150X050	340/308/340 116	BTRM34-250X050
324/308/324 116 SS	BTRM34-150X050 SS	340/308/340 116 SS	BTRM34-250X050 SS
324/312/324 116	BTRM34-150X075	340/312/340 116	BTRM34-250X075
324/312/324 116 SS	BTRM34-150X075 SS	340/312/340 116 SS	BTRM34-250X075 SS
324/316/324 116	BTRM34-150X100	340/316/340 116	BTRM34-250X100
324/316/324 116 SS	BTRM34-150X100 SS	340/316/340 116 SS	BTRM34-250X100 SS
324/320/324 116	BTRM34-150X125	340/320/340 116	BTRM34-250X125
324/320/324 116 SS	BTRM34-150X125 SS	340/320/340 116 SS	BTRM34-250X125 SS
324/48.3F	FFC34-150	340/324/340 116	BTRM34-250X150
324/48.3F SS	FFC34-150 SS	340/324/340 116 SS	BTRM34-250X150 SS
324/M12	RFTM34-150	340/332/340 116	BTRM34-250X200



## Part.No Equivalence Hydra Pipe (Tube-Mac) - GS-Hydro flange parts

GS-Hydro	Hydra Pipe	GS-Hydro	Hydra Pipe
340/332/340 116 SS	<b>BTRM34-250X200 SS</b>	40/60X5 FA SS	<b>COR-60X5-250X200SS</b>
340/73.03F	<b>FFC34-250</b>	40/60X5 FB	<b>CFR-60X5-250X200</b>
340/73.03F SS	<b>FFC34-250 SS</b>	40/60X5 FB SS	<b>CFR-60X5-250X200SS</b>
340/M12	<b>RFTM34-250</b>	40/73.03X5.16 FA	<b>CO-SCH40-250</b>
340/M12 SS	<b>RFTM34-250 SS</b>	40/73.03X5.16 FA	<b>CO-SCH40-250 SS</b>
340F	<b>FFCM34-250-75MM</b>	40/73.03X5.16 FB	<b>CF-SCH40-250</b>
340F SS	<b>FFCM34-250-75MM SS</b>	40/73.03X5.16 FB	<b>CF-SCH40-250 SS</b>
340F/M12	<b>FFTM34-250-75MM</b>	40/73.03X7.01 FA	<b>CO-SCH80-250</b>
340F/M12 SS	<b>FFTM34-250-75MM SS</b>	40/73.03X7.01 FA	<b>CO-SCH80-250 SS</b>
348 115	<b>BEM34-300</b>	40/73.03X7.01 FB	<b>CF-SCH80-250</b>
348 115 SS	<b>BEM34-300 SS</b>	40/73.03X7.01 FB	<b>CF-SCH80-250 SS</b>
348 116 SS	<b>BTM34-300 SS</b>	40/73.03X9.53 FA	<b>CO-SCH160-250</b>
348 125	<b>BFOM34-300</b>	40/73.03X9.53 FA	<b>CO-SCH160-250 SS</b>
348 125 SS	<b>BFOM34-300 SS</b>	40/73.03X9.53 FB	<b>CF-SCH160-250</b>
348 125B	<b>BFFM34-300</b>	40/73.03X9.53 FB	<b>CF-SCH160-250 SS</b>
348 125B SS	<b>BFFM34-300 SS</b>	40/73X7 FA	<b>CO-73X7-250</b>
348 SS	<b>RFC34-400 SS</b>	40/73X7 FA SS	<b>CO-73X7-250 SS</b>
348/308/348 116	<b>BTRM34-300X050</b>	40/73X7 FB	<b>CF-73X7-250</b>
348/308/348 116 SS	<b>BTRM34-300X050 SS</b>	40/73X7 FB SS	<b>CF-73X7-250 SS</b>
348/312/348 116	<b>BTRM34-300X075</b>	40/75X3 FA	<b>CO-75X3-250</b>
348/312/348 116 SS	<b>BTRM34-300X075 SS</b>	40/75X3 FA SS	<b>CO-75X3-250 SS</b>
348/316/348 116	<b>BTRM34-300X100</b>	40/75X3 FB	<b>CF-75X3-250</b>
348/316/348 116 SS	<b>BTRM34-300X100 SS</b>	40/75X3 FB SS	<b>CF-75X3-250 SS</b>
348/320/348 116	<b>BTRM34-300X125</b>	40/75X5 FA	<b>CO-75X5-250</b>
348/320/348 116 SS	<b>BTRM34-300X125 SS</b>	40/75X5 FA SS	<b>CO-75X5-250 SS</b>
348/324/348 116	<b>BTRM34-300X150</b>	40/75X5 FB	<b>CF-75X5-250</b>
348/324/348 116 SS	<b>BTRM34-300X150 SS</b>	40/75X5 FB SS	<b>CF-75X5-250 SS</b>
348/332/348 116	<b>BTRM34-300X200</b>	40018 SS	<b>RFE-250 SS</b>
348/332/348 116 SS	<b>BTRM34-300X200 SS</b>	40019 SS	<b>RFBH-250 SS</b>
348/340/348 116	<b>BTRM34-300X250</b>	432 SS	<b>RFC74-200 SS</b>
348/340/348 116 SS	<b>BTRM34-300X250 SS</b>	440 115	<b>BEM74-250</b>
348/88.9F	<b>FFC34-300</b>	440 115 SS	<b>BEM74-250 SS</b>
348/88.9F SS	<b>FFC34-300 SS</b>	440 116 SS	<b>BTM74-250 SS</b>
348/M16	<b>RFTM34-300</b>	440 125	<b>BFOM74-250</b>
348/M16 SS	<b>RFTM34-300 SS</b>	440 125 SS	<b>BFOM74-250 SS</b>
348F	<b>FFCM34-300-90MM</b>	440 125B	<b>BFFM74-250</b>
348F SS	<b>FFCM34-300-90MM SS</b>	440 125B SS	<b>BFFM74-250 SS</b>
348F/M16	<b>FFTM34-300-90MM</b>	440 SS	<b>RFC74-250 SS</b>
348F/M16 SS	<b>FFTM34-300-90MM SS</b>	440/332/440 116	<b>BTRM7-34-250X200</b>
40/60.3X3.91 FA	<b>COR-SCH40-250X200</b>	440/332/440 116 SS	<b>BTRM7-34-250X200SS</b>
40/60.3X3.91 FA SS	<b>CORSCH40-</b>	440/632/440 116	<b>BTRM7-64-250X200</b>
40/60.3X3.91 FB	<b>CFR-SCH40-250X200</b>	440/632/440 116 SS	<b>BTRM7-64-250X200SS</b>
40/60.3X3.91 FB SS	<b>CFRSCH40-250X200SS</b>	440/73.03F SS	<b>FFC74-250 SS</b>
40/60.3X5.54 FA	<b>COR-SCH80-250X200</b>	440F	<b>FFCM74-250-75MM</b>
40/60.3X5.54 FA SS	<b>CORSCH80-</b>	440F SS	<b>FFCM74-250-75MM SS</b>
40/60.3X5.54 FB	<b>CFR-SCH80-250X200</b>	448 115	<b>BEM74-300</b>
40/60.3X5.54 FB SS	<b>CFRSCH80-250X200SS</b>	448 115 SS	<b>BEM74-300 SS</b>
40/60X5 FA	<b>COR-60X5-250X200</b>	448 116 SS	<b>BTM74-300 SS</b>

## Part.No Equivalence Hydra Pipe (Tube-Mac) - GS-Hydro flange parts

GS-Hydro	Hydra Pipe	GS-Hydro	Hydra Pipe
448 125	<b>BFOM74-300</b>	48/88.9X7.67 FA	<b>CO-SCH80-300</b>
448 125 SS	<b>BFOM74-300 SS</b>	48/88.9X7.67 FA SS	<b>CO-SCH80-300 SS</b>
448 125B	<b>BFFM74-300</b>	48/88.9X7.67 FB	<b>CF-SCH80-300</b>
448 125B SS	<b>BFFM74-300 SS</b>	48/88.9X7.67 FB SS	<b>CF-SCH80-300 SS</b>
448 SS	<b>RFC74-300 SS</b>	48/90X3 FB	<b>CF-90X3.5-300</b>
448/332/448 116	<b>BTRM7-34-300X200</b>	48/90X3 FB SS	<b>CF-90X3.5-300 SS</b>
448/332/448 116 SS	<b>BTRM7-34-300X200SS</b>	48/90X3.5 FA	<b>CO-90X3.5-300</b>
448/440/448 116	<b>BTRM74-300X250</b>	48/90X3.5 FA SS	<b>CO-90X3.5-300 SS</b>
448/440/448 116 SS	<b>BTRM74-300X250 SS</b>	48/90X5 FA	<b>CO-90X5-300</b>
448/632/448 116	<b>BTRM7-64-300X200</b>	48/90X5 FA SS	<b>CO-90X5-300 SS</b>
448/632/448 116 SS	<b>BTRM7-64-300X200SS</b>	48/90X5 FB	<b>CF-90X5-300</b>
448F	<b>FFCM74-300-90MM</b>	48/90X5 FB SS	<b>CF-90X5-300 SS</b>
448F SS	<b>FFCM74-300-90MM SS</b>	48018 SS	<b>RFE-300 SS</b>
456 115	<b>BEM74-400</b>	48019 SS	<b>RFBH-300 SS</b>
456 115	<b>BTM74-400</b>	56/101.6X5.74 FA	<b>CO-SCH40-350</b>
456 115 SS	<b>BEM74-400 SS</b>	56/101.6X5.74 FA	<b>CO-SCH40-350 SS</b>
456 116 SS	<b>BTM74-400 SS</b>	56/101.6X5.74 FB	<b>CF-SCH40-350</b>
456 125	<b>BFOM74-400</b>	56/101.6X5.74 FB	<b>CF-SCH40-350 SS</b>
456 125 SS	<b>BFOM74-400 SS</b>	56018 SS	<b>RFE-400 SS</b>
456 125B	<b>BFFM74-400</b>	56019 SS	<b>RFBH-400 SS</b>
456 125B SS	<b>BFFM74-400 SS</b>	608 115	<b>BEM64-050</b>
456 SS	<b>RFC74-400 SS</b>	608 115 SS	<b>BEM64-050 SS</b>
456/332/456 116	<b>BTRM7-34-400X200</b>	608 116 SS	<b>BTM64-050 SS</b>
456/332/456 116 SS	<b>BTRM7-34-400X200SS</b>	608 125	<b>BFOM64-050</b>
456/440/456 116	<b>BTRM74-400X250</b>	608 125 SS	<b>BFOM64-050 SS</b>
456/440/456 116 SS	<b>BTRM74-400X250 SS</b>	608 125B	<b>BFFM64-050</b>
456/448/456 116	<b>BTRM74-400X300</b>	608 125B SS	<b>BFFM64-050 SS</b>
456/448/456 116 SS	<b>BTRM74-400X300 SS</b>	608 SS	<b>RFC64-050 SS</b>
456/632/456 116	<b>BTRM7-64-400X200</b>	608/21.3F	<b>FFC64-050</b>
456/632/456 116 SS	<b>BTRM7-64-400X200SS</b>	608/21.3F SS	<b>FFC64-050 SS</b>
456F	<b>FFCM74-400-115MM</b>	608/M8	<b>RFTM64-050</b>
456F SS	<b>FFCM74-400-115MM</b>	608/M8 SS	<b>RFTM64-050 SS</b>
48/73.03X5.16 FA	<b>COR-SCH40-300X250</b>	608F	<b>FFCM64-050-25MM</b>
48/73.03X5.16 FA SS	<b>CORSCH40-</b>	608F SS	<b>FFCM64-050-25MM SS</b>
48/73.03X5.16 FB	<b>CFR-SCH40-300X250</b>	608F/M8	<b>FFTM64-050-25MM</b>
48/73.03X5.16 FB SS	<b>CFRSCH40-300X250SS</b>	608F/M8 SS	<b>FFTM64-050-25MM SS</b>
48/73.03X7.01 FA	<b>COR-SCH80-300X250</b>	612 115	<b>BEM64-075</b>
48/73.03X7.01 FA SS	<b>CORSCH80-</b>	612 115 SS	<b>BEM64-075 SS</b>
48/73.03X7.01 FB	<b>CFR-SCH80-300X250</b>	612 116 SS	<b>BTM64-075 SS</b>
48/73.03X7.01 FB SS	<b>CFRSCH80-300X250SS</b>	612 125	<b>BFOM64-075</b>
48/75X5 FA	<b>COR-75X5-300X250</b>	612 125 SS	<b>BFOM64-075 SS</b>
48/75X5 FA SS	<b>COR-75X5-300X250SS</b>	612 125B	<b>BFFM64-075</b>
48/75X5 FB	<b>CFR-75X5-300X250</b>	612 125B SS	<b>BFFM64-075 SS</b>
48/75X5 FB SS	<b>CFR-75X5-300X250SS</b>	612 SS	<b>RFC64-075 SS</b>
48/88.9X5.49 FA	<b>CO-SCH40-300</b>	612/26.7F	<b>FFC64-075</b>
48/88.9X5.49 FA SS	<b>CO-SCH40-300 SS</b>	612/26.7F SS	<b>FFC64-075 SS</b>
48/88.9X5.49 FB	<b>CF-SCH40-300</b>	612/608/612 116	<b>BTRM64-075X050</b>
48/88.9X5.49 FB SS	<b>CF-SCH40-300 SS</b>	612/608/612 116 SS	<b>BTRM64-075X050 SS</b>

## Part.No Equivalence Hydra Pipe (Tube-Mac) - GS-Hydro flange parts

GS-Hydro	Hydra Pipe	GS-Hydro	Hydra Pipe
612/M10	RFTM64-075	624/612/624 116 SS	BTRM64-150X075 SS
612/M10 SS	RFTM64-075 SS	624/616/624 116	BTRM64-150X100
612F	FFCM64-075-30MM	624/616/624 116 SS	BTRM64-150X100 SS
612F SS	FFCM64-075-30MM SS	624/620/624 116	BTRM64-150X125
612F/M10	FFTM64-075-30MM	624/620/624 116 SS	BTRM64-150X125 SS
612F/M10 SS	FFTM64-075-30MM SS	624/M16	RFTM64-150
616 115	BEM64-100	624/M16 SS	RFTM64-150 SS
616 115 SS	BEM64-100 SS	624F	FFCM64-150-50MM
616 116 SS	BTM64-100 SS	624F SS	FFCM64-150-50MM SS
616 125	BFOM64-100	624F/M16	FFTM64-150-50MM
616 125 SS	BFOM64-100 SS	624F/M16 SS	FFTM64-150-50MM SS
616 125B	BFFM64-100	632 115	BEM64-200
616 125B SS	BFFM64-100 SS	632 115 SS	BEM64-200 SS
616 SS	RFC64-100 SS	632 116 SS	BTM64-200 SS
616/33.4F	FFC64-100	632 125	BFOM64-200
616/33.4F SS	FFC64-100 SS	632 125 SS	BFOM64-200 SS
616/608/616 116	BTRM64-100X050	632 125B	BFFM64-200
616/608/616 116 SS	BTRM64-100X050 SS	632 125B SS	BFFM64-200 SS
616/612/616 116	BTRM64-100X075	632 SS	RFC64-200 SS
616/612/616 116 SS	BTRM64-100X075 SS	632/60.3F	FFC64-200
616/M12	RFTM64-100	632/60.3F SS	FFC64-200 SS
616/M12 SS	RFTM64-100 SS	632/608/632 116	BTRM64-200X050
616F	FFCM64-100-38MM	632/608/632 116 SS	BTRM64-200X050 SS
616F SS	FFCM64-100-38MM SS	632/612/632 116	BTRM64-200X075
616F/M12	FFTM64-100-38MM	632/612/632 116 SS	BTRM64-200X075 SS
616F/M12 SS	FFTM64-100-38MM SS	632/616/632 116	BTRM64-200X100
620 115	BEM64-125	632/616/632 116 SS	BTRM64-200X100 SS
620 115 SS	BEM64-125 SS	632/620/632 116	BTRM64-200X125
620 116 SS	BTM64-125 SS	632/620/632 116 SS	BTRM64-200X125 SS
620 125	BFOM64-125	632/624/632 116	BTRM64-200X150
620 125 SS	BFOM64-125 SS	632/624/632 116 SS	BTRM64-200X150 SS
620 125B	BFFM64-125	632/M20	RFTM64-200
620 125B SS	BFFM64-125 SS	632/M20 SS	RFTM64-200 SS
620 SS	RFC64-125 SS	632F	FFCM64-200-60MM
620/42.2F	FFC64-125	632F SS	FFCM64-200-60MM SS
624 115	BEM64-150	632F/M20	FFTM64-200-60MM
624 115 SS	BEM64-150 SS	632F/M20 SS	FFTM64-200-60MM SS
624 116 SS	BTM64-150 SS	64/114.3X6.02 FA	CO-SCH40-400
624 125	BFOM64-150	64/114.3X6.02 FA	CO-SCH40-400 SS
624 125 SS	BFOM64-150 SS	64/114.3X6.02 FB	CF-SCH40-400
624 125B	BFFM64-150	64/114.3X6.02 FB	CF-SCH40-400 SS
624 125B SS	BFFM64-150 SS	64/114.3X8.56 FA	CO-SCH80-400
624 SS	RFC64-150 SS	64/114.3X8.56 FA	CO-SCH80-400 SS
624/48.3F	FFC64-150	64/114.3X8.56 FB	CF-SCH80-400
624/48.3F SS	FFC64-150 SS	64/114.3X8.56 FB	CF-SCH80-400 SS
624/608/624 116	BTRM64-150X050	64/115X4 FA	CO-115X4-400
624/608/624 116 SS	BTRM64-150X050 SS	64/115X4 FA SS	CO-115X4-400 SS
624/612/624 116	BTRM64-150X075	64/141.3	RA-500



## Part.No Equivalence Hydra Pipe (Tube-Mac) - GS-Hydro flange parts

GS-Hydro	Hydra Pipe	GS-Hydro	Hydra Pipe
64018SCHXXS	RFE-500	RB440-332 SS	TPRM7-34-250X200SS
64018SCHXXS SS	RFE-500 SS	RB440-332 SS	TPRM7-64-250X200SS
80/168.3	RA-600	RB448-332	TPRM7-34-300X200
80018SCHXXS	RFE-600	RB448-332	TPRM7-64-300X200
80018SCHXXS SS	RFE-600 SS	RB448-332 SS	TPRM7-34-300X200SS
864/141.3	RFAC48-500	RB448-332 SS	TPRM7-64-300X200SS
864/141.3 SS	RFAC48-500 SS	RB448-340	TPRM7-34-300X250
880/168.3	RFAC48-600	RB448-340 SS	TPRM7-34-300X250SS
880/168.3 SS	RFAC48-600 SS	RB448-440	TPRM74-300X250
88018SCHXXS	RFE-800	RB448-440 SS	TPRM74-300X250 SS
88018SCHXXS SS	RFE-800 SS	RB456-332	TPRM7-64-400X200
888/219.1	RFAC48-800	RB456-332 SS	TPRM7-64-400X200SS
888/219.1 SS	RFAC48-800 SS	RB456-340	TPRM7-34-400X250
88X	RA-800	RB456-340 SS	TPRM7-34-400X250SS
L 64/115X4 FB	CF-115X4-400	RB456-348	TPRM7-34-400X300
L 64/115X4 FB SS	CF-115X4-400 SS	RB456-348 SS	TPRM7-34-400X300SS
RB312-308	TPRM34-075X050	RB456-440	TPRM74-400X250
RB312-308 SS	TPRM34-075X050 SS	RB456-440 SS	TPRM74-400X250 SS
RB316-308	TPRM34-100X050	RB456-448	TPRM74-400X300
RB316-308 SS	TPRM34-100X050 SS	RB456-448 SS	TPRM74-400X300 SS
RB316-312	TPRM34-100X075	RB612-308	TPRM6-34-075X050
RB316-312 SS	TPRM34-100X075 SS	RB612-308 SS	TPRM6-34-075X050SS
RB320-312	TPRM34-125X075	RB612-608	TPRM64-075X050
RB320-312 SS	TPRM34-125X075 SS	RB612-608 SS	TPRM64-075X050 SS
RB320-316	TPRM34-125X100	RB616-308	TPRM6-34-100X050
RB320-316 SS	TPRM34-125X100 SS	RB616-308 SS	TPRM6-34-100X050SS
RB324-316	TPRM34-150X100	RB616-312	TPRM6-34-100X075
RB324-316 SS	TPRM34-150X100 SS	RB616-312 SS	TPRM6-34-100X075SS
RB324-320	TPRM34-150X125	RB616-608	TPRM64-100X050
RB324-320 SS	TPRM34-150X125 SS	RB616-608 SS	TPRM64-100X050 SS
RB332-320	TPRM34-200X125	RB616-612	TPRM64-100X075
RB332-320 SS	TPRM34-200X125 SS	RB616-612 SS	TPRM64-100X075 SS
RB332-324	TPRM34-200X150	RB620-312	TPRM6-34-125X075
RB332-324 SS	TPRM34-200X150 SS	RB620-312 SS	TPRM6-34-125X075SS
RB340-324	TPRM34-250X150	RB620-316	TPRM6-34-125X100
RB340-324 SS	TPRM34-250X150 SS	RB620-316 SS	TPRM6-34-125X100SS
RB340-332	TPRM34-250X200	RB620-612	TPRM64-125X075
RB340-332 SS	TPRM34-250X200 SS	RB620-612 SS	TPRM64-125X075 SS
RB348-332	TPRM34-300X200	RB620-616	TPRM64-125X100
RB348-332 SS	TPRM34-300X200 SS	RB620-616 SS	TPRM64-125X100 SS
RB348-340	TPRM34-300X250	RB624-316	TPRM6-34-150X100
RB348-340 SS	TPRM34-300X250 SS	RB624-316 SS	TPRM6-34-150X100SS
RB440-324	TPRM7-34-250X150	RB624-320	TPRM6-34-150X125
RB440-324	TPRM7-64-250X150	RB624-320 SS	TPRM6-34-150X125SS
RB440-324 SS	TPRM7-34-250X150SS	RB624-616	TPRM64-150X100
RB440-324 SS	TPRM7-64-250X150SS	RB624-616 SS	TPRM64-150X100 SS
RB440-332	TPRM7-34-250X200	RB624-620	TPRM64-150X125
RB440-332	TPRM7-64-250X200	RB624-620 SS	TPRM64-150X125 SS

## Part.No Equivalence Hydra Pipe (Tube-Mac) - GS-Hydro flange parts

GS-Hydro	Hydra Pipe	GS-Hydro	Hydra Pipe
RB632-320	TPRM6-34-200X125	RBE456-332	TPROM7-64-400X200
RB632-320 SS	TPRM6-34-200X125SS	RBE456-332 SS	TPROM764-400X200SS
RB632-324	TPRM6-34-200X150	RBE456-340	TPROM7-34-400X250
RB632-324 SS	TPRM6-34-200X150SS	RBE456-340 SS	TPROM734-400X250SS
RB632-620	TPRM64-200X125	RBE456-348	TPROM7-34-400X300
RB632-620 SS	TPRM64-200X125 SS	RBE456-348 SS	TPROM734-400X300SS
RB632-624	TPRM64-200X150	RBE456-440	TPROM74-400X250
RB632-624 SS	TPRM64-200X150 SS	RBE456-440 SS	TPROM74-400X250 SS
RBE312-308	TPROM34-075X050	RBE456-448	TPROM74-400X300
RBE312-308 SS	TPROM34-075X050 SS	RBE456-448 SS	TPROM74-400X300 SS
RBE316-308	TPROM34-100X050	RBE612-308	TPROM6-34-075X050
RBE316-308 SS	TPROM34-100X050 SS	RBE612-308 SS	TPROM634-075X050SS
RBE316-312	TPROM34-100X075	RBE612-608	TPROM64-075X050
RBE316-312 SS	TPROM34-100X075 SS	RBE612-608 SS	TPROM64-075X050 SS
RBE320-312	TPROM34-125X075	RBE616-308	TPROM6-34-100X050
RBE320-312 SS	TPROM34-125X075 SS	RBE616-312 SS	TPROM634-100X075SS
RBE320-316	TPROM34-125X100	RBE616-608	TPROM64-100X050
RBE320-316 SS	TPROM34-125X100 SS	RBE616-608 SS	TPROM64-100X050 SS
RBE324-316	TPROM34-150X100	RBE616-612	TPROM64-100X075
RBE324-316 SS	TPROM34-150X100 SS	RBE616-612 SS	TPROM64-100X075 SS
RBE324-320	TPROM34-150X125	RBE620-312	TPROM6-34-125X075
RBE324-320 SS	TPROM34-150X125 SS	RBE620-312 SS	TPROM634-125X075SS
RBE332-320	TPROM34-200X125	RBE620-316	TPROM6-34-125X100
RBE332-320 SS	TPROM34-200X125 SS	RBE620-316 SS	TPROM634-125X100SS
RBE332-324	TPROM34-200X150	RBE620-612	TPROM64-125X075
RBE332-324 SS	TPROM34-200X150 SS	RBE620-612 SS	TPROM64-125X075 SS
RBE340-324	TPROM34-250X150	RBE620-616	TPROM64-125X100
RBE340-324 SS	TPROM34-250X150 SS	RBE620-616 SS	TPROM64-125X100 SS
RBE340-332	TPROM34-250X200	RBE624-316	TPROM6-34-150X100
RBE340-332 SS	TPROM34-250X200 SS	RBE624-316 SS	TPROM634-150X100SS
RBE348-332	TPROM34-300X200	RBE624-320	TPROM6-34-150X125
RBE348-332 SS	TPROM34-300X200 SS	RBE624-320 SS	TPROM634-150X125SS
RBE348-340	TPROM34-300X250	RBE624-616	TPROM64-150X100
RBE348-340 SS	TPROM34-300X250 SS	RBE624-616 SS	TPROM64-150X100 SS
RBE440-324	TPROM7-34-250X150	RBE624-620	TPROM64-150X125
RBE440-324	TPROM7-64-250X150	RBE624-620 SS	TPROM64-150X125 SS
RBE440-324 SS	TPROM734-250X150SS	RBE632-320	TPROM6-34-200X125
RBE440-324 SS	TPROM764-250X150SS	RBE632-320 SS	TPROM634-200X125SS
RBE440-332	TPROM7-34-250X200	RBE632-324	TPROM6-34-200X150
RBE440-332 SS	TPROM734-250X200SS	RBE632-324 SS	TPROM634-200X150SS
RBE448-332	TPROM7-34-300X200	RBE632-620	TPROM64-200X125
RBE448-332	TPROM7-64-300X200	RBE632-620 SS	TPROM64-200X125 SS
RBE448-332 SS	TPROM734-300X200SS	RBE632-624	TPROM64-200X150
RBE448-332 SS	TPROM764-300X200SS	RBE632-624 SS	TPROM64-200X150 SS
RBE448-340	TPROM7-34-300X250	RF1208	CR075-050
RBE448-340 SS	TPROM734-300X250SS	RF12-08 SS	CR-075X050 SS
RBE448-440	TPROM74-300X250	RF16-08	CR-100X050
RBE448-440 SS	TPROM74-300X250 SS	RF16-08 SS	CR-100X050 SS

## **Part.No Equivalence Hydra Pipe (Tube-Mac) - GS-Hydro flange parts**

<b>GS-Hydro</b>	<b>Hydra Pipe</b>
RF16-12	CR-100X075
RF16-12 SS	CR-100X075 SS
RF20-12	CR-125X075
RF20-12 SS	CR-125X075 SS
RF2016	CR125-100
RF20-16	CR-125X100
RF20-16 SS	CR-125X100 SS
RF24-16	CR-150X100
RF24-16 SS	CR-150X100 SS
RF2420	CR150-125
RF24-20	CR-150X125
RF24-20 SS	CR-150X125 SS
RF32-20	CR200-125
RF32-20 SS	CR-200X125 SS
RF32-24	CR-200X150
RF32-24 SS	CR-200X150 SS
RF40-24	CR-250X150
RF40-24 SS	CR-250X150 SS
RF40-32	CR-250X200
RF40-32 SS	CR-250X200 SS
RF48-32	CR-300X200
RF48-32 SS	CR-300X200 SS
RF48-40	CR-300X250
RF48-40 SS	CR-300X250 SS
RF56-40	CR-400X250
RF56-40 SS	CR-400X250 SS
RF56-48	CR-400X300
RF56-48 SS	CR-400X300 SS



# Prefabricated piping spools

Hydra Pipe supplies prefabricated high pressure (350bar) piping spools up to size 190 x 20mm complete with flange end connections, flushed and tested acc. to customers requirements.

We also supplies custom made special piping spools up to 16" for all kind of applications also material handling



CAD DESIGN

